

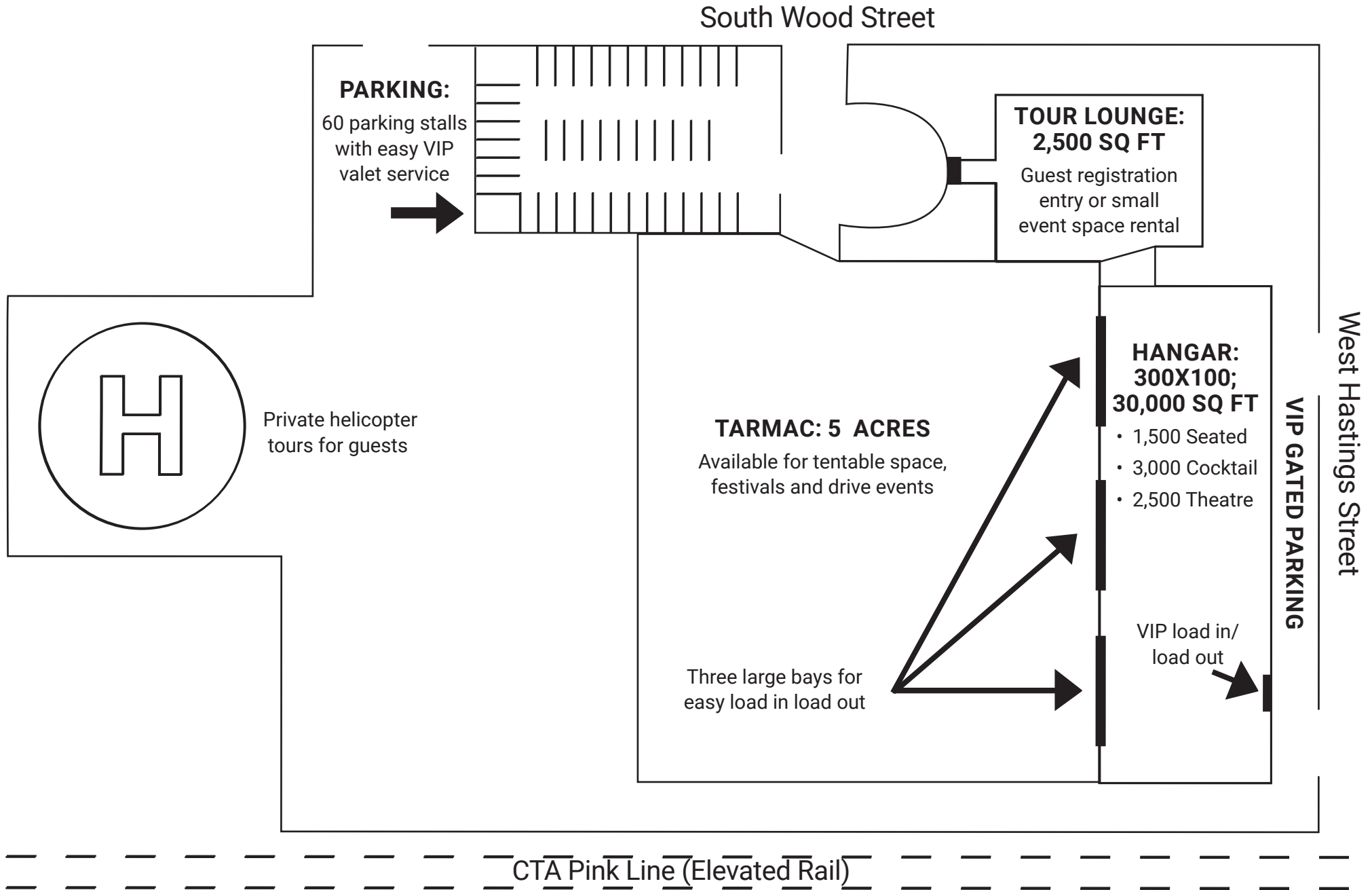

EVENT CAPACITY FLOORPLANS

Vertiport Chicago Floorplan



Vertiport Chicago Floorplan – Hangar

**HANGAR:
300X100;
30,000 SQ FT**

- 1,500 Seated
- 3,000 Cocktail
- 2,500 Theatre
- 4,200 Concert

**HANGAR DOORS:
75 FT WIDE X
25 FT TALL**

- Three large bays for easy load in load out
- Opens to tentable tarmac to triple the event footprint

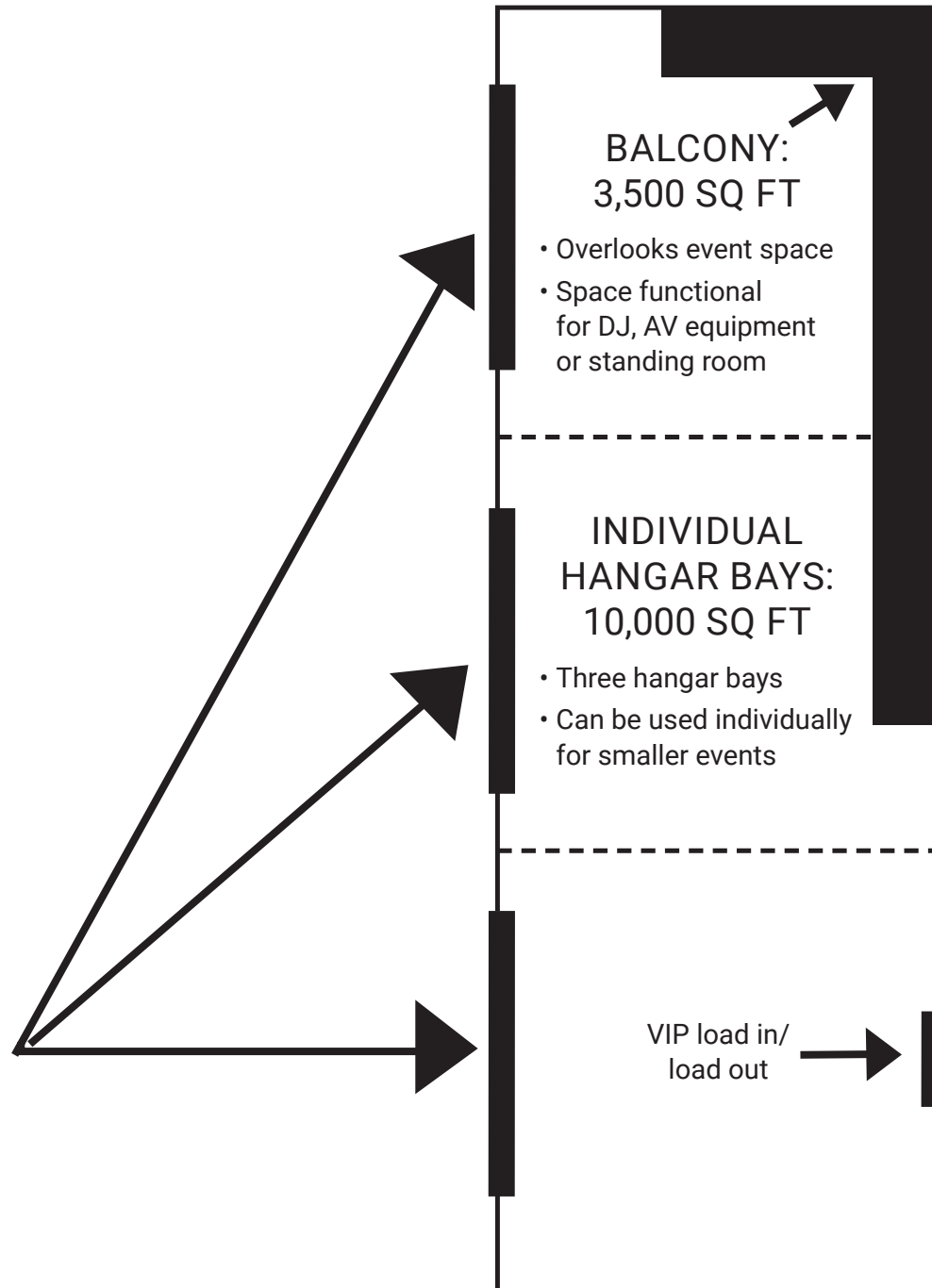

Vertiport Chicago Floorplan – Tour Lounge

TARMAC →



TOUR LOUNGE
2500 TOTAL SQ FT

VIP Lounge

Conference Room

Registration Kiosks

Men's Restroom

Women's Restroom

Catering
Prep Area

PARKING

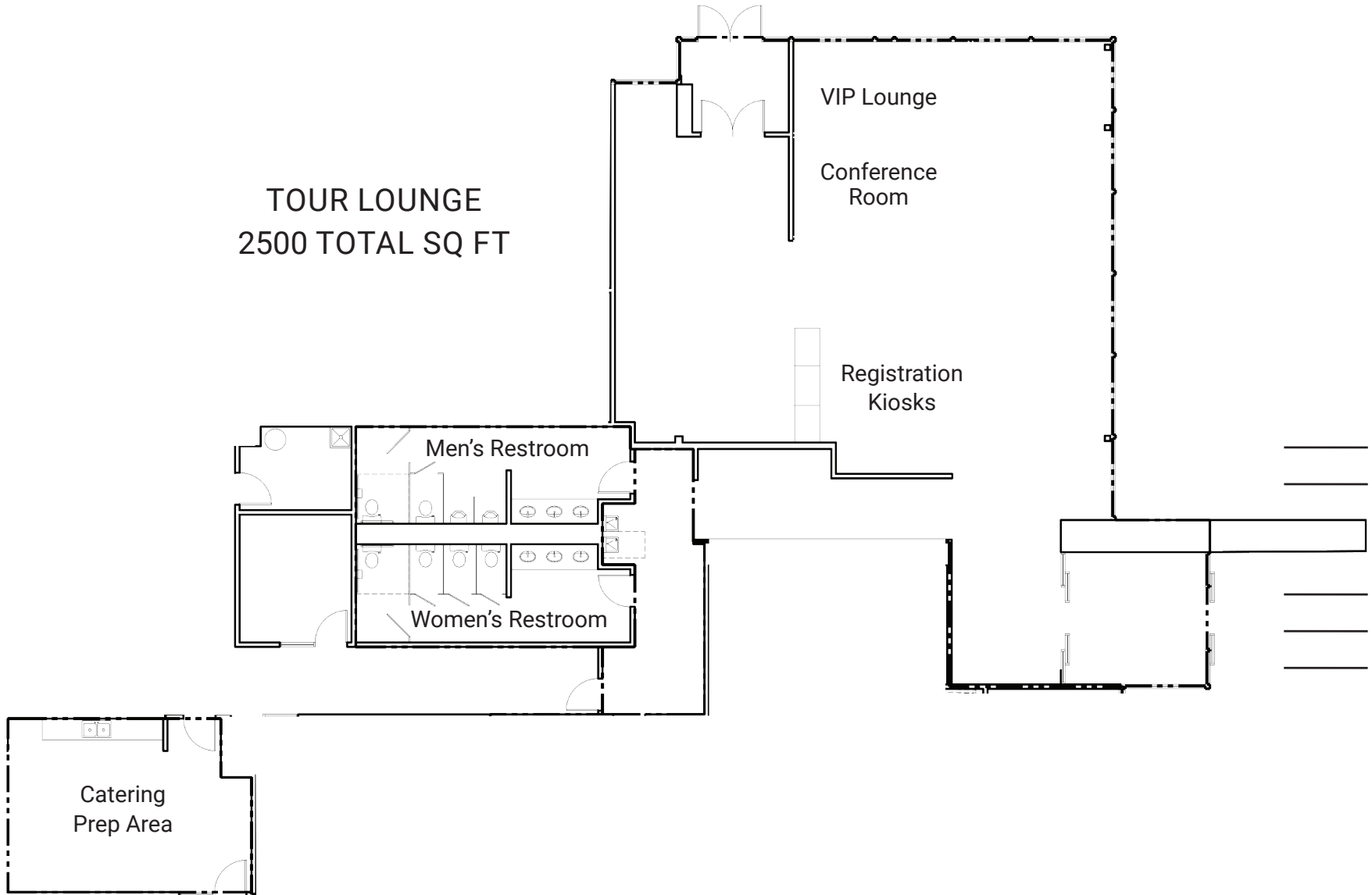

Contact Information

Contact us today to plan your next event or arrange a site visit:

Vertiport Chicago
1339 S. Wood Street
Chicago, IL 60608

312.995.6109

Events@vertiportchicago.com

www.vertiportchicago.com

